

Wall Expansion Joint Profile

Product Information

Product Model	RCC
Product Type	Wall Expansion Joint Cover
Material	Aluminum Alloy 6063 T6
Finish	Mill finish

Introducing our RCC profile—a straightforward and efficient solution for wall joints, tailored to simplify both installation and maintenance. Constructed from robust aluminum, this profile is designed to offer a hassle-free and durable answer to your joint requirements. Furthermore, the integration of a rubber gasket guarantees a seamless connection with the walls, effectively averting any scratches during movement.

Features and Benefits



Versatility

This profile is adaptable to various architectural styles and design preferences.



Corrosion Resistance

Crafted from corrosion-resistant materials, ensuring long-term durability even in challenging environments.



Ease of Customization

Allows for easy customization to meet specific project requirements, ensuring a tailored solution.



Quick Installation

Streamlined design facilitates a fast and straightforward installation process, saving time and labor costs.



Low Maintenance

Minimal maintenance is required, reducing the overall cost of ownership and upkeep.

Maintenance

- > Regularly inspect the expansion joint cover for signs of damage or wear.
- > Clean with mild soap and water as needed to maintain appearance.

Code	Gap width A(mm)	Visible width B(mm)	Total movement (mm)
RCC 50	50	135	70mm (+30 -40)
RCC 75	75	170	105mm (+40 -65)
RCC 100	100	210	145mm (+55 -90)
RCC 150	150	270	205mm (+65 -140)

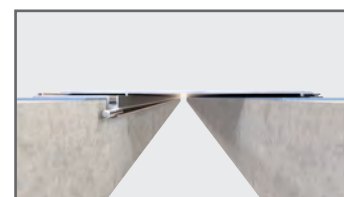
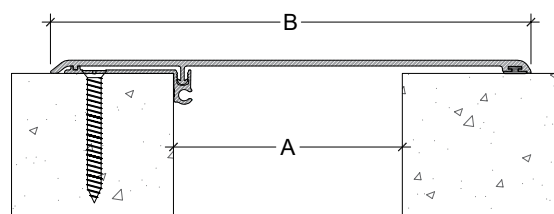

Length	Standard length: 3 meters.
Fire Rating	ASTM E84 Class A.
Installation	Please follow the installation instructions provided in the J-CAP installation guide.