

Wall Expansion Joint Profile

Product Information

Product Model	JW
Product Type	Wall Expansion Joint Cover
Material	Aluminum Alloy 6063 T6
Finish	Mill finish

This sleek and stylish cover not only offers a nice appearance but also boasts easy installation and impressive movement capacity. It's designed to provide a sophisticated finishing touch while ensuring functional convenience.

Features and Benefits



High-Quality Aluminum Construction

Durability and longevity, ensuring the cover remains in excellent condition over time.



Sleek and Stylish Design

Enhances the aesthetics of your space, adding a touch of sophistication.



Easy Installation

Saves time and effort during setup.



Low-Maintenance Design

Requires minimal upkeep, reducing long-term maintenance costs and efforts.



Form and Function Combined

The cover strikes a balance between visual appeal and practicality, making it a versatile solution.

Maintenance

- > Regularly inspect the expansion joint cover for signs of damage or wear.
- > Clean with mild soap and water as needed to maintain appearance.

Code	Gap width A(mm)	Visible width B(mm)	Total movement (mm)
JW 25	25	95	45mm (+25 -20)
JW 50	50	145	80mm (+40 -40)
JW 75	75	170	105mm (+40 -65)
JW 100	100	195	130mm (+40 -90)
JW 150	150	245	180mm (+40 -140)
JW 200	200	300	235mm (+45 -190)
JW 250	250	350	285mm (+45 -240)

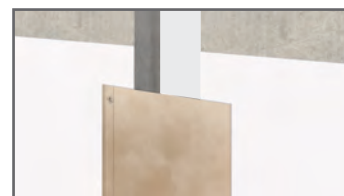
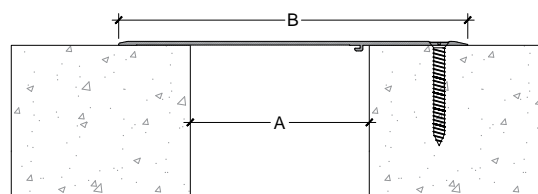

Length	Standard length: 3 meters.
Fire Rating	ASTM E84 Class A.
Installation	Please follow the installation instructions provided in the J-CAP installation guide.