

# Floor (Roof-Corner) Expansion Joint Profile

## Product Information

<b>Product Model</b>	JR-C
<b>Product Type</b>	Floor-Wall (Roof-Corner) Expansion Joint Cover/Seismic Profile
<b>Material</b>	Aluminum Alloy 6063 T6
<b>Finish</b>	Mill finish

Introducing our JR-C Floor-Wall (Roof-Corner) Seismic Profile, tailored for applications on concrete upstands in non-walkable areas. This profile excels in establishing a sturdy and water-tight connection among structural components, emphasizing high movement capacity and extended lifespan. Designed for unparalleled performance during seismic events, it integrates seamlessly with aluminum flashing, featuring a multi-rubber gasket system for enhanced structural robustness and a water-tight seal—providing dual protection for your project.

## Features and Benefits



**Seismic Movement Capability**  
Designed to accommodate horizontal and vertical movements caused by seismic activity.



**Water Tight Design**  
Specially designed for water-tight connections, preventing water infiltration for enhanced durability.



**Aluminum Flashing Compatibility**  
Structurally designed to seamlessly accept aluminum flashing, providing additional weather protection.



**Durable Construction**  
Made from high-strength aluminum alloy for exceptional durability and long service life.



**Multi Rubber Gasket**  
Equipped with a multi-rubber gasket system to ensure a smooth and water-tight connection between profile parts.



**Easy Installation**  
Quick and hassle-free installation process with clear instructions provided.

## Maintenance

- > Regularly inspect the expansion joint cover for signs of damage or wear.
- > Clean with mild soap and water as needed to maintain appearance.

Code	Gap width A(mm)	Cover width B(mm)	Installation height C(mm)	Total movement (mm)	Load Capacity
JR 25C	25	128	50	50mm (+30 -20)	Not applicable
JR 35C	35	138	50	70mm (+40 -30)	Not applicable
JR 50C	50	153	50	95mm (+50 -45)	Not applicable
JR 75C	75	176	50	130mm (+60 -70)	Not applicable
JR 100C	100	200	50	140mm (+60 -80)	Not applicable
JR 150C	150	252	50	195mm (+65 -130)	Not applicable
JR 200C	200	303	50	245mm (+65 -180)	Not applicable
JR 250C	250	353	50	295mm (+65 -230)	Not applicable
JR 300C	300	403	50	345mm (+65 -280)	Not applicable
JR 400C	400	503	50	445mm (+65 -380)	Not applicable

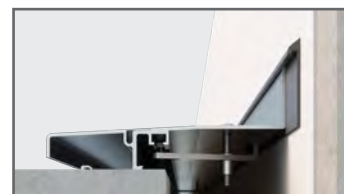
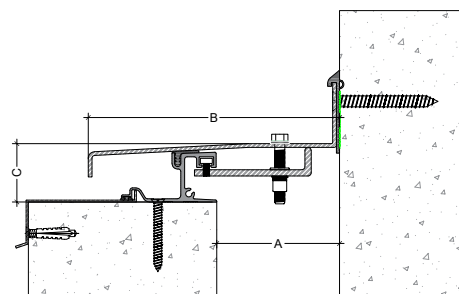

<b>Length</b>	Standard length: 3 meters.
<b>Fire Rating</b>	ASTM E84 Class A.
<b>Installation</b>	Please follow the installation instructions provided in the J-CAP installation guide.
<b>Note</b>	The use of the turn bars is not applicable for gaps up to 75mm