

# Ceiling Expansion Joint Profile

## Product Information

<b>Product Model</b>	JFC
<b>Product Type</b>	Ceiling Expansion Joint Cover
<b>Material</b>	Aluminum Alloy 6063 T6, EPDM Rubber Gaskets
<b>Finish</b>	Mill finish
<b>Gasket colors</b>	Black, Grey, Beige

Introducing our JFC Ceiling Expansion Joint Profile – a sleek and versatile solution compatible with various false ceiling types. Crafted from Aluminum with a smooth rubber appearance, this screwless profile combines aesthetics with practicality, offering easy installation and universal compatibility.

## Features and Benefits



**Durable Aluminum Brackets**  
Ensures long-lasting performance and structural integrity.



**EPDM Rubber insert**  
Provides excellent flexibility, allowing the profile to adapt to varying conditions without cracking or deteriorating.



**Easy Installation**  
Simplifies the installation process, saving time and labor costs.



**Applicability**  
Compatible with various false ceiling types and board thicknesses.



**Low Maintenance**  
Requires minimal upkeep, reducing ongoing operational costs and maintenance efforts.

## Maintenance

- > Regularly inspect the expansion joint cover for signs of damage or wear.
- > Clean with mild soap and water as needed to maintain appearance.

Code	Gap width A(mm)	Visible width B(mm)	Total movement (mm)
JFC 25	25	62	10mm (+5 -5)
JFC 35	35	72	15mm (+7.5 -7.5)
JFC 50	50	87	30mm (+15 -15)
JFC 75	75	112	40mm (+20 -20)
JFC 100	100	137	50mm (+25 -25)

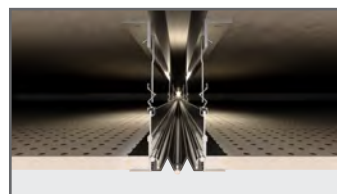
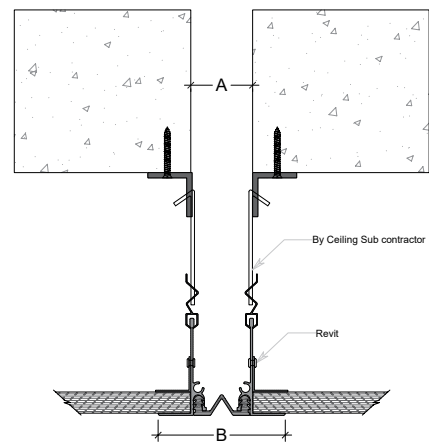

<b>Length</b>	Standard length: 3 meters.
<b>Fire Rating</b>	ASTM E84 Class A.
<b>Installation</b>	Please follow the installation instructions provided in the J-CAP installation guide.